

Labtex

AATCC M6 WASHING MACHINE
MODEL: LBT-M6



OPERATION INSTRUCTION

[Version 2.2x]

INDEX

I. IMPORTANT SAFETY INSTRUCTIONS	2
II. INTRODUCTION	
1. Definition of Use	4
III. PARTS DESCRIPTION	
1. Control Panel	5
A. Water Level Control Knob	6
B. Water Temperature Monitoring Device	6
C. Main Control Panel & Program Selector Knob	7
Table 1: Pre-set Program List	8
2. Precision Water Temperature Control Device	9
3. Accessories	9
IV. BEFORE START	
1. Dimensions	10
2. Specifications	11
V. INSTALLATION	12
VI. ELECTRICAL REQUIREMENT	13
VII. OPERATION	14
VIII. MAINTENANCE	15
IX. TRANSPORT/HANDLING	17
X. NOTE	18

OPERATION INSTRUCTION

I. IMPORTANT SAFETY INSTRUCTIONS

BEFORE USING THIS INSTRUMENT, READ ALL INSTRUCTIONS AND CAUTIONARY MARKINGS IN THIS MANUAL

Throughout this manual and on machine decals, you will find precautionary statements (“Warning” and “Important”) followed by specific instructions. These precautions are intended for the personal safety of the operator, user, servicer, and those maintaining the machine.

 WARNING	<p>Indicates a hazardous situation that, if not avoided, could cause severe personal injury or death.</p>
---	---

 IMPORTANT	<p>Inform the reader of specific procedures where minor machine damage will occur if the procedure is not followed.</p>
---	---

 CAUTION	<p>Indicates a hazardous situation that, if not avoided, may cause minor or moderate personal injury or property damages.</p>
---	---

OPERATION INSTRUCTION



Use the washing machine only for its intended purpose, washing textiles, clothes or fabrics. Any others materials are prohibited.

When using an electrical appliance, basic precautions should always be followed, including the following:



For your safety and to reduce the fire or an explosion, do not store or use gasoline or other flammable vapors and liquids in the vicinity of this or any appliance.



The circuit in the instrument is high voltage, please do not open the instrument for non-maintenance personnel.

TO REDUCE THE RISK OF FIRE, ELECTRIC SHOCK, OR INJURY:

1. Use only as described in this Instruction Manual. Do not carry out any maintenance other than that shown in this manual.
2. Do not handle any part of the plug or machine with wet hands.
3. Do not use with a damaged cord or plug. If the supply cord is damaged it must be replaced by a qualified persons in order to avoid a hazard.
4. Keep this instruction manual by the specialist in a safe place.
5. If the machine is not working as it should, has received a sharp blow, has been dropped, damaged, left outdoors, or dropped into water, do not use and contact your supplier / distributor.
6. Contact the supplier / distributor when service or repair is required. Do not disassemble the machine as incorrect reassembly may result in an electric shock or fire.
7. Do not stretch the cord or place the cord under strain. Keep the cord away from heated surfaces. Do not close a door on the cord, or pull the cord around sharp edges or corners. Arrange the cord away from traffic areas and where it will not be stepped on or tripped over. Do not run over the cord.
8. When handling the instrument, do not use violence to avoid damage to the instrument.
9. The instrument is used normal environment, use an elevation of less than 2,000 meters.

READ AND SAVE THESE INSTRUCTIONS

II. INTRODUCTION

1. Definition of Use

The Labtex Washing Machine LBT-M6 is exclusively destined to wash and spin machine washable laundry which is mainly for laboratory and meet the parameters which listed on AATCC LP1 Table I, IIC, IID, IIIA and IIIB.

METHOD	DESCRIPTION
AATCC 88B	Seam Smoothness in Fabrics after Home Laundering
AATCC 88C	Crease Retention in Fabrics after Home Laundering
AATCC 124	Smoothness Appearance of Fabrics after Home Laundering
AATCC 130	Soil Release: Oily Stain Release Method
AATCC 135	Dimensional Changes of Fabrics after Home Laundering
AATCC 142	Appearance of Flocked Fabric after Repeated Home Laundering and/or Coin-Op Drycleaning
AATCC 143	Appearance of Apparel and Other Textile End Products After Home Laundering
AATCC 150	Dimensional Changes of Garments after Home Laundering
AATCC 172	Colorfastness to Powdered Non-Chlorine Bleach in Home Laundering
AATCC 179	Skew Change in Fabrics After Home Laundering

This manual are used to helps the operator to use the washer correctly.

III. PARTS DESCRIPTION

1. Control Panel

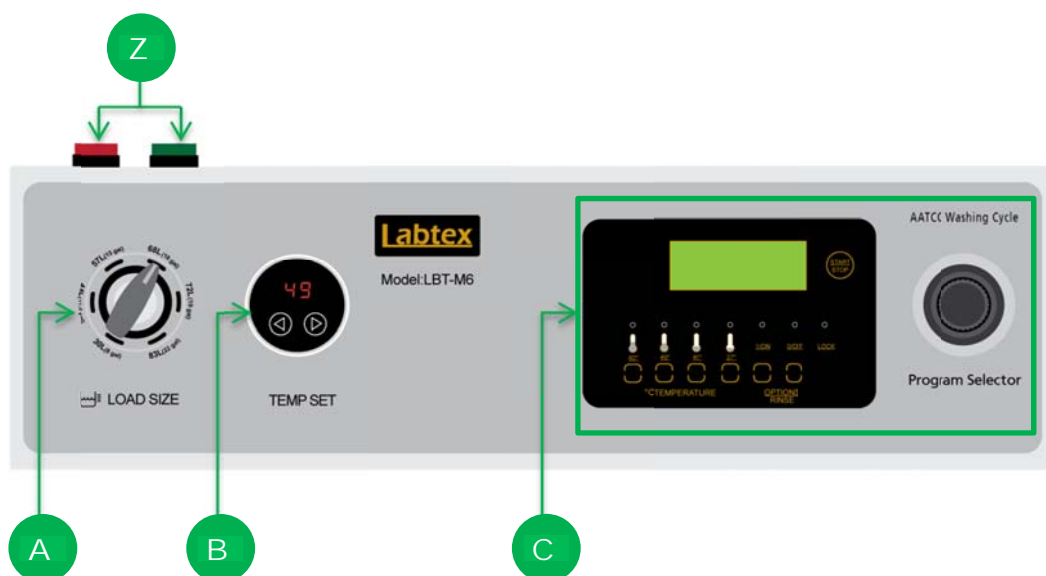

ITEM	DESCRIPTION
Z	Washer Status Indication Lamps When Red Lamp Lit: Washer stopped or Pause When Green Lamp Lit: Washer operating
A	Water Level Control Knob
B	Water Temperature Monitoring Device
C	Main Control Panel & Program Selector Knob

OPERATION INSTRUCTION

A. Water Level Control Knob



Choose From 6 Different Load Sizes

Liter	30	44	57	68	72	83
Gallon	8	11.5	15	18	19	22

**Please refer to AATCC Standard requirements*

B. Water Temperature Monitoring Device

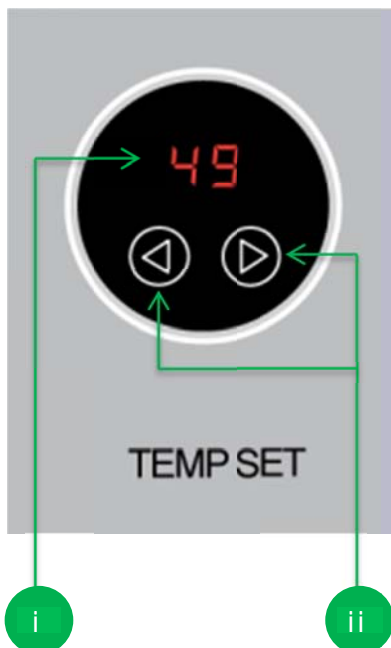

- Monitoring water temperature
(25°C~60°C±2°C) flows into the washtub
- Set monitoring temperature value:
Press the Left ◀ /Right ▶ Button and
select the temperature on the screen while the
display flashing.

OPERATION INSTRUCTION

C. Main Control Panel & Program Selector Knob



<p>140-0002-0 AATCC LPI-2018 88B, 88C, 124, 135, 150-2018 Table I Normal (19gal, 86spm, 16min, 660rpm, 5min)</p>	<p>i. LCD Display Screen: Shows washing cycles and progressing sequence while processing</p>
<p>°C TEMPERATURE</p>	<p>ii. Washing Temperature Select Button: 4 basic temperature value as 27°C, 41°C, 49°C & 60°C</p>
<p>OPTIONS RINSE</p>	<p>iii. Options Rinse: 1/ON = Extra 1 rinse procedure 0/OFF = Normal washing cycle</p>
<p>AATCC Washing Cycle Program Selector</p>	<p>iv. Program Selector Knob: Washing cycles are shown in Table 1</p>

OPERATION INSTRUCTION

Table 1: Preset Program

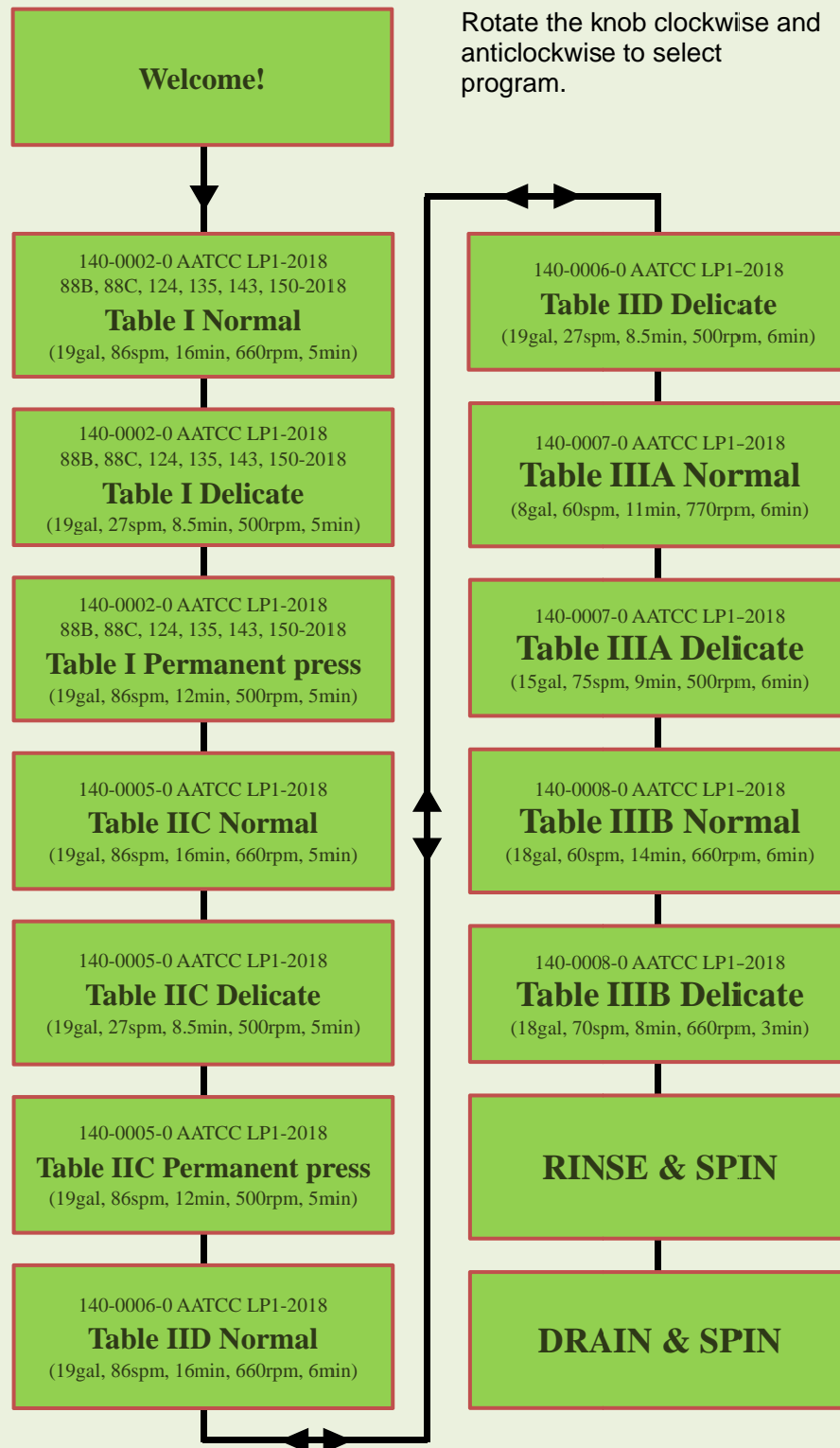

OPERATION INSTRUCTION

2. Precision Water Temperature Control Device

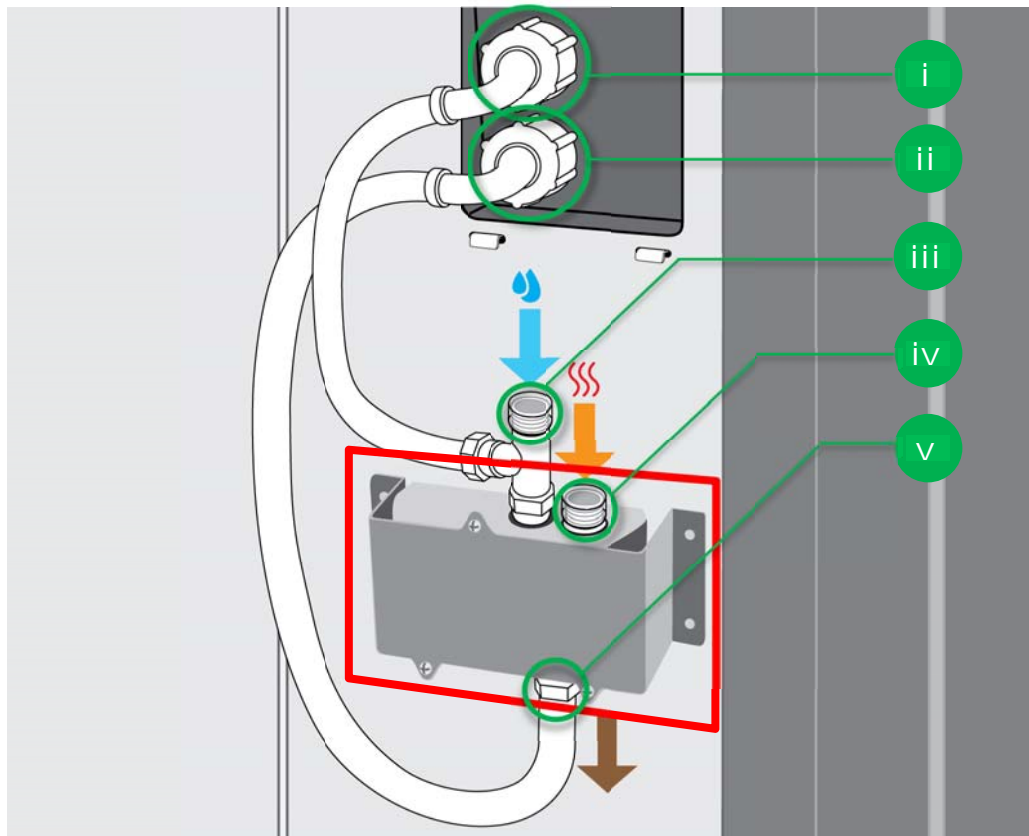

9

ITEM	DESCRIPTION
i	Tap water connection to washtub
ii	Mixed water connection to washtub
iii	Cold water connection
iv	Hot water connection
v	Mixed water outlet

3. Accessories

- i. Fill Hose
- ii. Hose adaptor
- iii. Rubber Foot
- iv. Filter Screen

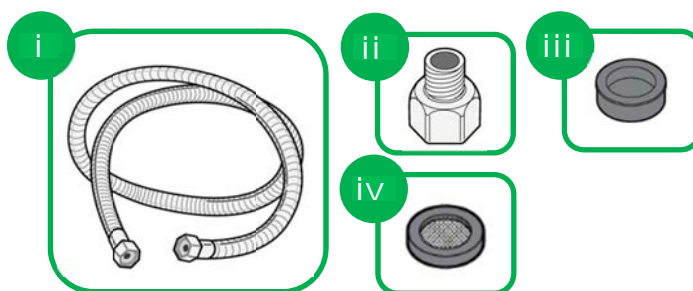

IV. BEFORE START

1. Dimensions:

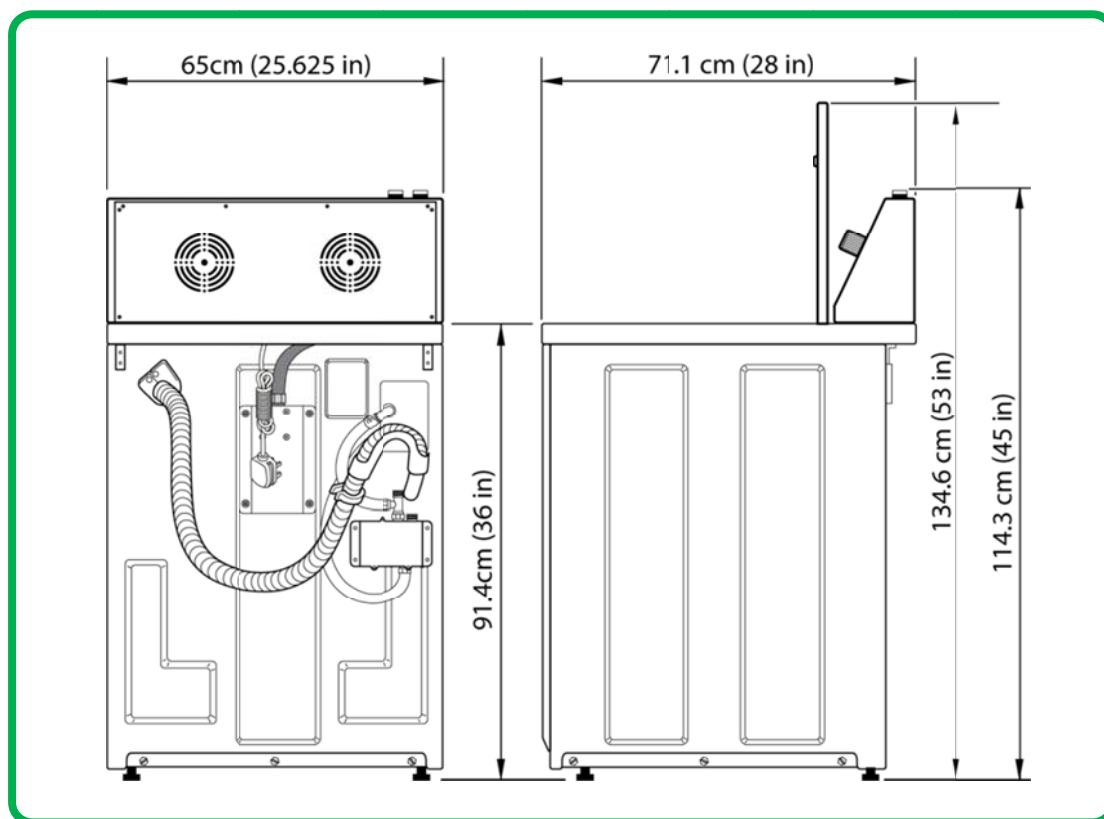

10

Before install the washer,
the basic tools you may need
are:

- i. Wrench
- ii. Screwdriver
- iii. Pliers
- iv. Level

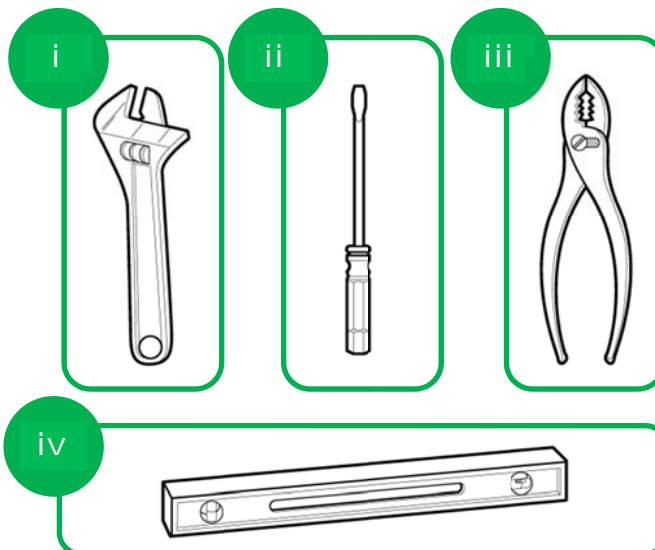

OPERATION INSTRUCTION

2. Specifications:

Model	LBT-M6
Meet Standard	AATCC 88B, 88C, 124, 130, 135, 142, 143, 150, 172, 179
Washing Cycles	Normal, Permanent Press, Delicate for AATCC Drain & Spin, Rinse & Spin Customized
Pre-Programmed Cycle	AATCC LP1-2018 Table I, IIC, IID, IIIA, IIIB
Water Level (gal)	22 +/-1 or Customized
Agitation Speed (spm)	60 – 179 +/- 2 or Customized
Washing Time (min)	8 – 9999 or Customized
Final Spin Speed (rpm)	430 – 770 +/- 15 or Customized
Final Spin Time (min)	5 or Customized
Durability Test	Maximum 9999 times or 9999 minutes or Customized
Water Input	Hot / Cold
Mixed Water Control	25 ~ 60+/-1°C (wash) Tap Water (Rinse)
Washing Load	10.5KG
Wash Tub	Stainless Steel
Agitator	Plastic Flex Vane Post
Sound power level	Maximum L _{WA} 79 dB
Power	110-240V~; 50-50Hz; 1000 W; IPX4
Packing Size (mm)	700 x 680 x 1040
Gross Weight (Kg)	78
Packing Weight (Kg)	140

OPERATION INSTRUCTION

V. INSTALLATION

1. Remove the shipping case and take out machine from packing carton.
2. Wipe out inside of washtub
3. Connect fill hoses, make sure both COLD and HOT Faucet had been connect to Temperature Control Device.
4. Connect drain hose to drain receptacle
5. Position and level the washer.
6. Connect the washer to Electrical Power

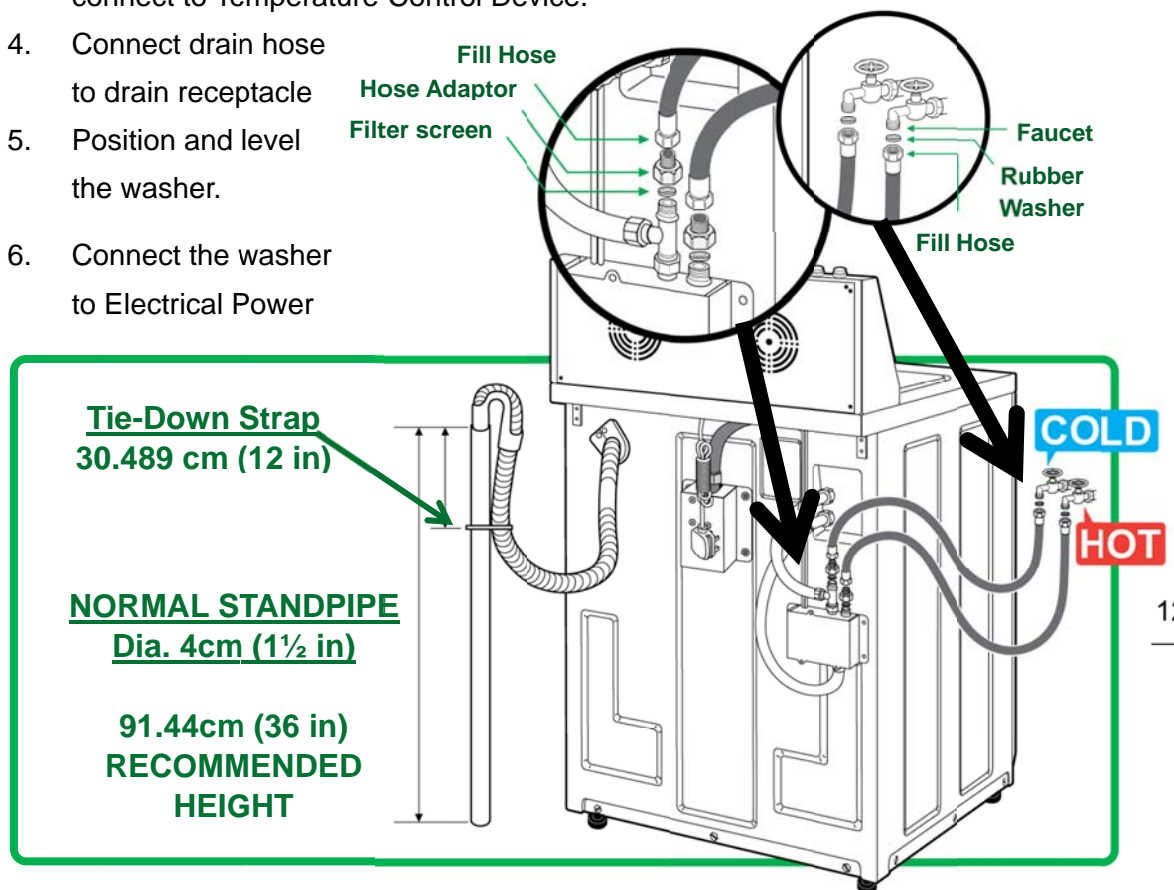

12

!
IMPORTANT

Thread hose couplings onto valve connections finger tight, then turn 1/4 turn with pliers. DO NOT cross thread or overtighten couplings.

VI. ELECTRICAL REQUIREMENT

220V/50Hz/1KW Or 120V/60Hz/1.5KW

 WARNING	<p>To reduce the risk of fire, electrical shock, serious injury or death, all wiring and protective earth/ground connections MUST conform with the latest edition of the National Electrical Code, ANSI/NFPA No. 70, and such local regulations as might apply. It is the customer's responsibility to have the wiring, fuses and circuit breakers installed by a qualified electrician to make sure adequate electrical power is available to the washer.</p>
---	---

When plugging in the Labtex M6:

- DO NOT overload circuits.
- DO NOT use an adapter.
- DO NOT use an extension cord.
- The machine is designed to be operated on a separate branch, polarized three-wire, effectively grounded (earthed) 110-240 V~, 50-60 Hz, AC (alternating current), circuit protected by a **15 ampere fuse**, equivalent fusetrone or circuit breaker.
- The three-prong grounding plug on the power cord should be plugged directly into a polarized three-slot effectively grounded receptacle rated 220 Volts or 120 Volts AC (alternating current) 15 Amps.
- Do not modify the plug provided with the washer – if it will not fit the outlet, have a proper outlet installed by a qualified electrician.

VII. OPERATION

Follow below example:

1. Power on Washer.
2. Select a washing cycle by turning the Program Selector Knob (Refer to Table I and AATCC test method)
3. Turn the Water Level Control Knob to select a water level (Refer to AATCC test method)
4. Select a testing temperature, e.g. "49°C" on the program panel
5. Adjust the water inlet temp. control to "49°C".
6. Press "START" button to fill water into the washtub.
7. When the water level (filling stopped) and temperature reach the setting, press on the "Start" button again to pause the washing cycle, open the lid and add the **detergent**, **test specimen** and the **ballasts** into the washer.
8. Close the lid and press on the start button to run the washing cycle.
9. The washer will run and finish automatically. The "Red" indication lamp will be "Lit" after washing cycle completed.

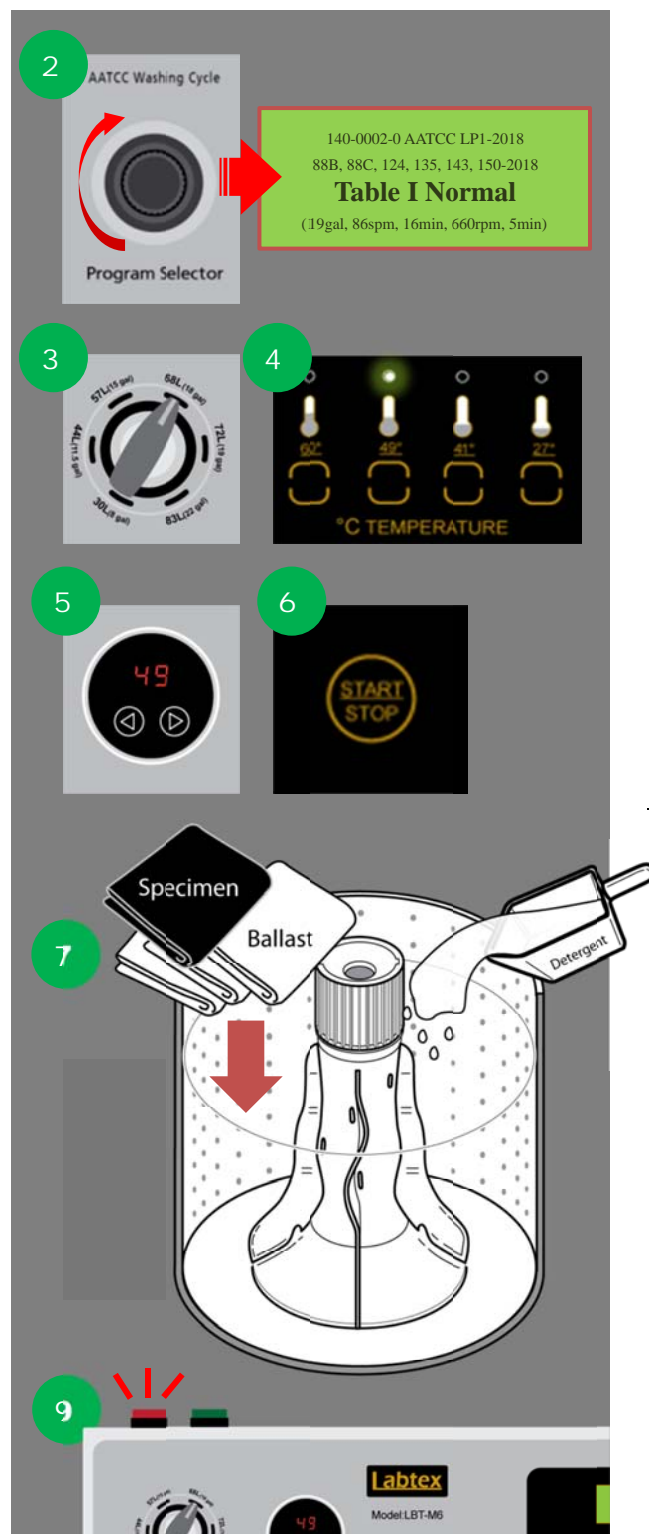

VIII. MAINTENANCE

Cold Weather Care

If the washer is delivered on a cold day (below freezing), or is stored in an unheated room or area during the cold months, do not attempt to operate it until the washer has had a chance to warm up.

Care of Your Washer

1. Use only a damp or sudsy cloth for cleaning the control panel.
2. Wipe the washer cabinet products are spilled on the cabinet, wipe immediately.
3. Do not use scouring pads or abrasive cleaners on any part of the washer.
4. The washtub will need no particular care though it may need rinsing or wiping after an unusual load has been washed.
5. Leave the lid open to allow the inside of the washers to dry out after use. This helps prevent musty odors from developing.

 <p>IMPORTANT</p>	<p>Hoses and other natural rubber parts deteriorate after extended use. Hoses may develop cracks, blisters or material wear from the temperature and constant high pressure they are subjected to.</p>
	<p>All hoses should be checked on a monthly basis for any visible signs of deterioration. Any hose showing the signs of deterioration listed above should be replaced immediately. All hoses should be replaced every five years.</p>

Vacations and Extended Non-Use

 <p>IMPORTANT</p>	<p>To avoid possible property damage due to flooding, turn off the water supply to the washer whenever there will be an extended period of non use.</p>
---	--

OPERATION INSTRUCTION

Filter Screens

Check the filter screen in the fill hoses for debris or damage annually. Clean or replace them if necessary.

If the washer is filling with water slower than normal, check the filter screens. Clean or replace them if necessary.

Motor Overload Protector

This internal overload protector will also stop the motor automatically in the event of an overload. The overload protector will reset itself in two or three minutes and the motor will restart automatically. If the overload protector stops the motor again, remove the washer from use and contact our agent / distributor.

Before You Call for Service

If the washer:

Won't Fill	Won't Start	Won't Agitate	Won't Spin	Possible Reason – Do This to Correct
●	●	●	●	Be sure power cord is plugged all the way into the electrical outlet.
	●	●	●	Close the lid
●	●	●	●	Check the house
	●	●	●	Has the motor overload protector cycled?
●				Turn on the hot and cold water faucets.
●	●	●	●	Push "START" button to start the washer.
●				Was the last spin completed?
●				Clean the screens in the water mixing valve and the filter screens in the fill hoses.
●				Water is siphoned from the washer during the cycle. Refer to Installation section
●	●			Are controls properly set?
		●	●	Broken drive belt. Call the service person.

IX. TRANSPORT/HANDLING

 WARNING	<p>Excessive Weight Hazard</p> <p>Use two or more people to move and install washer.</p> <p>Failure to do so can result in back or other injury.</p>
---	---

Never lift the appliance by the worktop when transporting

1. Pull out the mains plug
2. Turn off the tap
3. Check that machine door and detergent dispenser are properly closed
4. Disconnect the inlet and drain hoses
5. Eliminate all water from the hoses and from the appliance
6. Fit the transport bolts (obligatory)

Manufacturers:	Guangzhou Johnson Measurement and Control Technology Co. Ltd
Address:	Room 2001, No. 13 Heshui West, Shatai Road, Tianhe District, Guangzhou.
Website:	www.lab-wash.com
Email:	info@lab-wash.com

X. NOTE
